

1200 MW Thermal Plant Environmental Impact Assessment



Country
Algeria

Client
IBERDROLA

Date
2008

Sogreah Magelis' services

- ▶ Environmental Impact Assessment
- ▶ Environmental Management and Monitoring Plan
- ▶ Waste Management Plan
- ▶ Restoration Plan

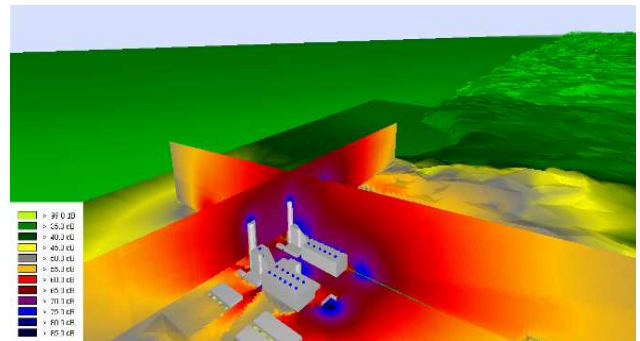

In the context of a 1200 MW Thermal plant construction project on the site of Koudiet Eddraouch (Algerian East coast), Sogreah Magelis performed an Environmental Assessment for Iberdrola. The production and the marketing of the electric power will be ensured by SKD Company.

The assessment is divided in several parts: the study of the Algerian legal requirements, the Environmental Baseline survey of the site, the Environmental Impact Assessment (EIA), the Environmental Monitoring and Management Plan, the waste management plan and the restoration plan.

For the baseline survey, Sogreah Magelis carried out a thorough study of the ecosystems, soils and social and economic aspects of the project area.



The impacts of the construction and production phases were evaluated through modelling of:

- ▶ Dispersion of atmospheric discharges; and
- ▶ Noise.

Measures for environmental protection were proposed for water supply, liquid discharge, atmospheric discharges, solid waste, noise, ecosystems, social and economic issues, etc.

The monitoring and environmental management plan was written to be used as a practical guide and methodology for the control of the measures suggested in the EIA.

The EIA is in conformity with the Algerian Regulation and the international standards.

MAG/MBN/MHE/140408